

A HYDROTURF® AT OUTFALL PIPE
1 PLAN
NTS

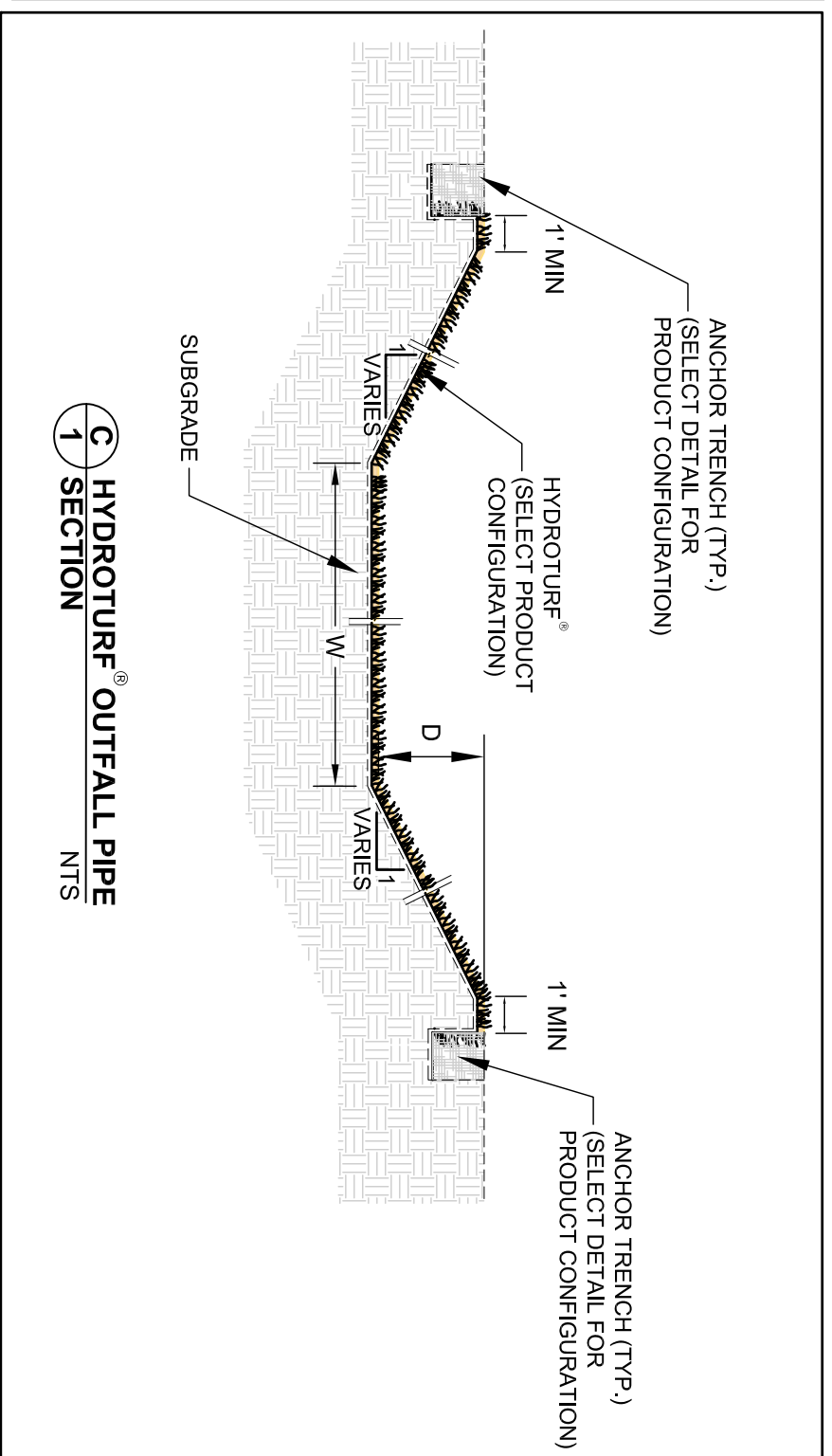

C HYDROTURF® OUTFALL PIPE
1 SECTION
NTS

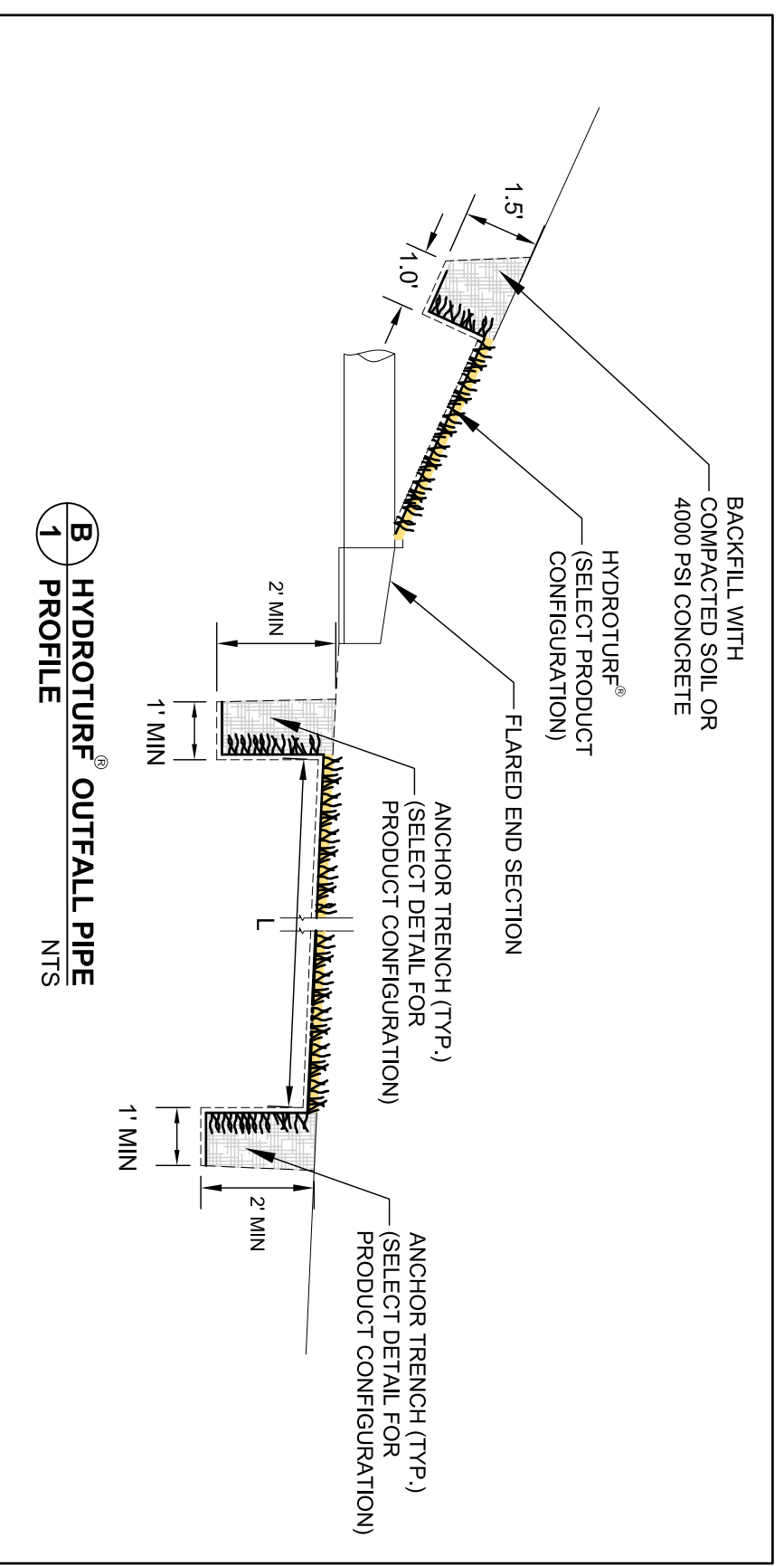

B HYDROTURF® OUTFALL PIPE
1 PROFILE
NTS

DISCLAIMER:
HYDROTURF® (or CLOSURETURF® or VERSACAP®) is a U.S. registered trademark which designates a product from Watershed Geosynthetics, LLC. This product is the subject of issued U.S. and foreign patents and/or pending U.S. and foreign patent applications. All information, recommendations and suggestions appearing in this literature concerning the use of our products are based upon test and data believed to be reliable; however, this information should not be used or relied upon for any specific application without independent professional examination and verification of accuracy, suitability and applicability. Since the actual use by others is beyond our control, no guarantee or warranty of any kind, expressed or implied, is made by Watershed Geosynthetics, LLC as to the effect of such use or the results to be obtained, nor does Watershed Geosynthetics, LLC assume any liability in connection herewith. Any statements made herein may not be absolutely complete since additional information may be necessary or desirable when particular or exceptional conditions or circumstances exist or because of applicable laws or government regulations. Nothing herein is to be construed as permission or as a recommendation to infringe any patent.

PRODUCT

TITLE			
HYDROTURF® REVETMENT SYSTEM AT OUTFALL PIPE			
FILE NO.	HTG_302r1_17048	SCALE	DATE
REV.	0	NTS	2/8/2017

FIGURE 1