

Notes:

1. The geomembrane component of HydroTurf® CS shall be in intimate contact with the anchor trench inside wall and bottom. Wrinkles, ripples, fish mouths, and/or bunching shall be removed and properly patched. During filling of the anchor trench with the compacted soil or concrete backfill, the contractor shall maintain that the geomembrane is in intimate contact with the trench wall and bottom. Concrete backfill shall be vibrated in place in accordance with standard industry techniques.
2. The geomembrane shall not extend up the outside wall of the anchor trench. It shall be trimmed short of the outside wall and shall extend a minimum of ¾ of the width of the anchor trench.
3. The engineered turf component of HydroTurf® CS shall be in intimate contact with the geomembrane. Wrinkles, ripples, fish mouths, and/or bunching shall be removed and properly patched. The engineered synthetic turf shall be trimmed so that it does not extend onto the bottom of the anchor trench. It shall be trimmed just short of the bottom and shall extend a minimum of ¾ of the depth of the anchor trench.

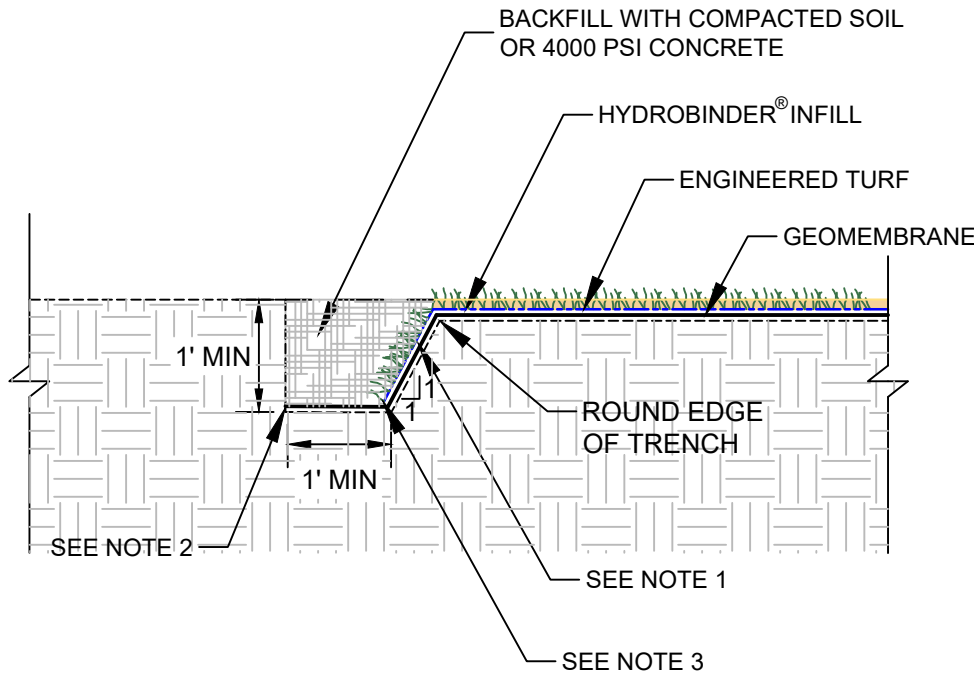

DISCLAIMER:

HYDROTURF® (or CLOSURETURF® or VERSACAP®) is a U.S. registered trademark which designates a product from Watershed Geosynthetics LLC. This product is the subject of issued U.S. and foreign patents and/or pending U.S. and foreign patent applications. All information, recommendations and suggestions appearing in this literature concerning the use of our products are based upon test and data believed to be reliable; however, this information should not be used or relied upon for any specific application without independent professional examination and verification of accuracy, suitability and applicability. Since the actual use by others is beyond our control, no guarantee or warranty of any kind, expressed or implied, is made by Watershed Geosynthetics, LLC as to the effect of such use or the results to be obtained, nor does Watershed Geosynthetics, LLC assume any liability in connection herewith. Any statements made herein may not be absolutely complete since additional information may be necessary or desirable when particular or exceptional conditions or circumstances exist or because of applicable laws or government regulations. Nothing herein is to be construed as permission or as a recommendation to infringe any patent.



PRODUCT

TITLE

**HYDROTURF® CS  
TYPICAL ANCHOR  
TRENCH TERMINATION**

File # HTTR-05-R00

Rev #	Scale	Date
0	NTS	2/8/2017

**FIGURE 1**